



Oz

The versatile farming assistant









# Oz

---

## A multi-task and multi-crop robot

Oz is the perfect companion for your field tasks, working with full autonomy.

Oz can weed between and on the rows, draw plantation lines, seed or plant and can help you in your work or carry weight for you.

It covers a wide range of crops and thanks to its GNSS RTK guidance the season start early and lasts long, no matter if the crop is already visible or already harvested.

Oz is perfect for: market gardening, nurseries, medicinal and aromatic plants, horticulture, seeds, etc.

It works in the field and in plastic tunnels.



## Technical specifications

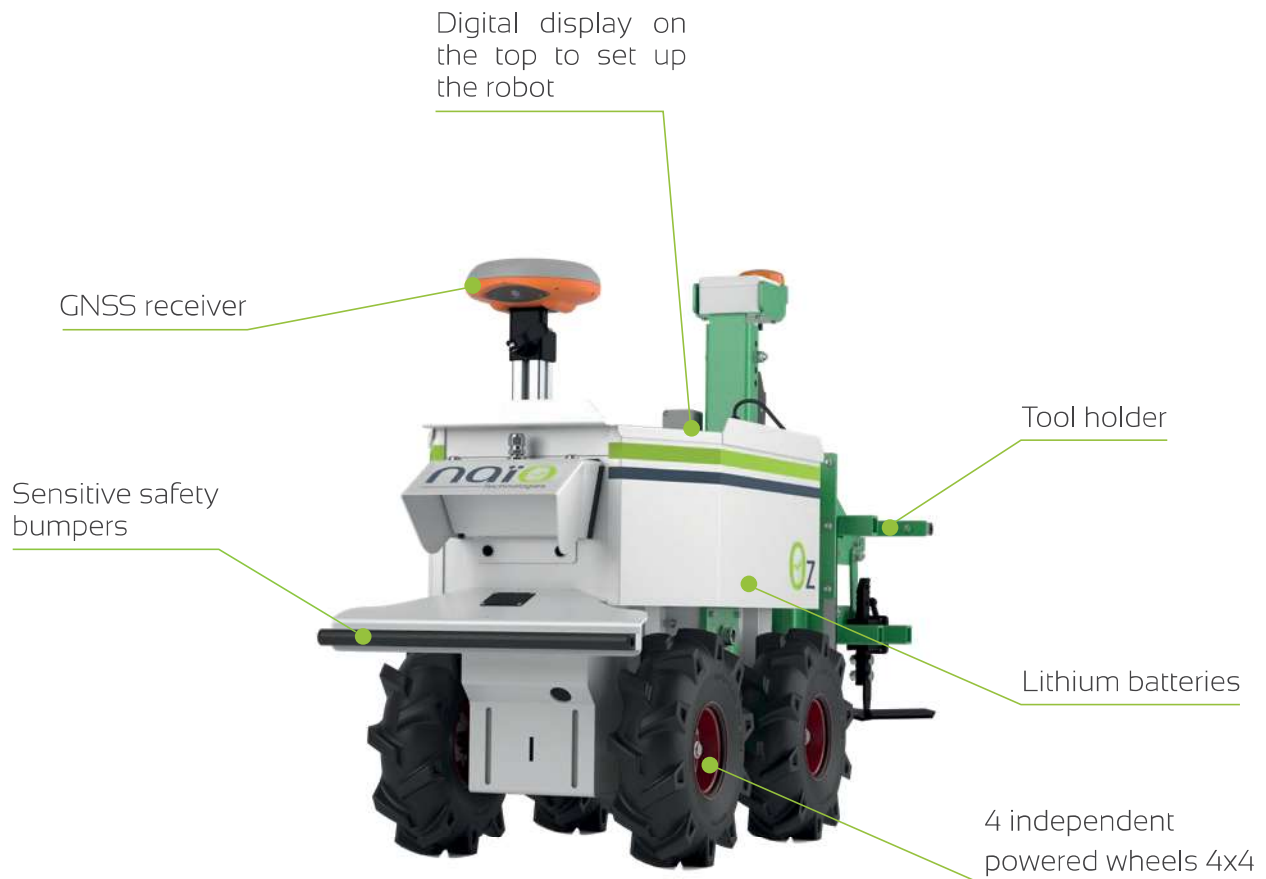

Navigation	GPS guidance (RTK GNSS)	Dimensions (without the tool holder)	L 98cm X W 42cm X H 84cm
Power source	100% electric Lithium batteries	Traction	4 power wheels 4 x 110 W motors
Autonomous use	Up to 8 hours	Average work rate	Up to 1000 m <sup>2</sup> / hour
Speed	Up to 1.8 km/h	Adaptable tools	Seed-drill, torsion spring, spiked-harrow, brushes, hoe blades, five-teeth harrow, planter, etc.
Weight	150 kg to 180 kg		
Towing capacity	150 kg	Other	Communication by SMS and modem
Carry on top	80 kg		

## Choose your Oz

### Step 1: choose your robot offer:

	<b>Oz Invest offer</b> The complete Oz investment: you own the robot with batteries and antenna.	<b>Oz&amp;Go offer</b> The melting between investment and rental: you own the robot and rent batteries and antenna.
Oz robot	✓	✓
Remote and charger	✓	✓
Robot and charger	✓	✓
100 Ah batteries	✓	Annual rental <i>Oz-Loc-Kit-Bat</i>
RTK GNSS receiver	✓	Annual rental <i>Oz-Loc-Kit-GPS</i>

### Step 2: choose your carrier and tools:



**Naïo's tools carrier**  
Reference: AM0013



**Carrier bar for Hak parallelograms**  
Reference: AH1330



**Coupling**  
Reference: AM0026

### Step 3: choose your delivery services:

- Delivery - Reference: Oz-Kit-Liv
- Half-day training - Reference: Acc-TK-Oz



## Choose your Oz

Step 4: choose your annual services subscription:

	Services Pack	Services Pack without RTK
RTK annual subscription	✓	-
Mobile connectivity SMS/Data	✓	✓
Guidance/Software updates	✓	✓
GPS maps management	✓	✓
Hotline 7/7 and online training materials	✓	✓

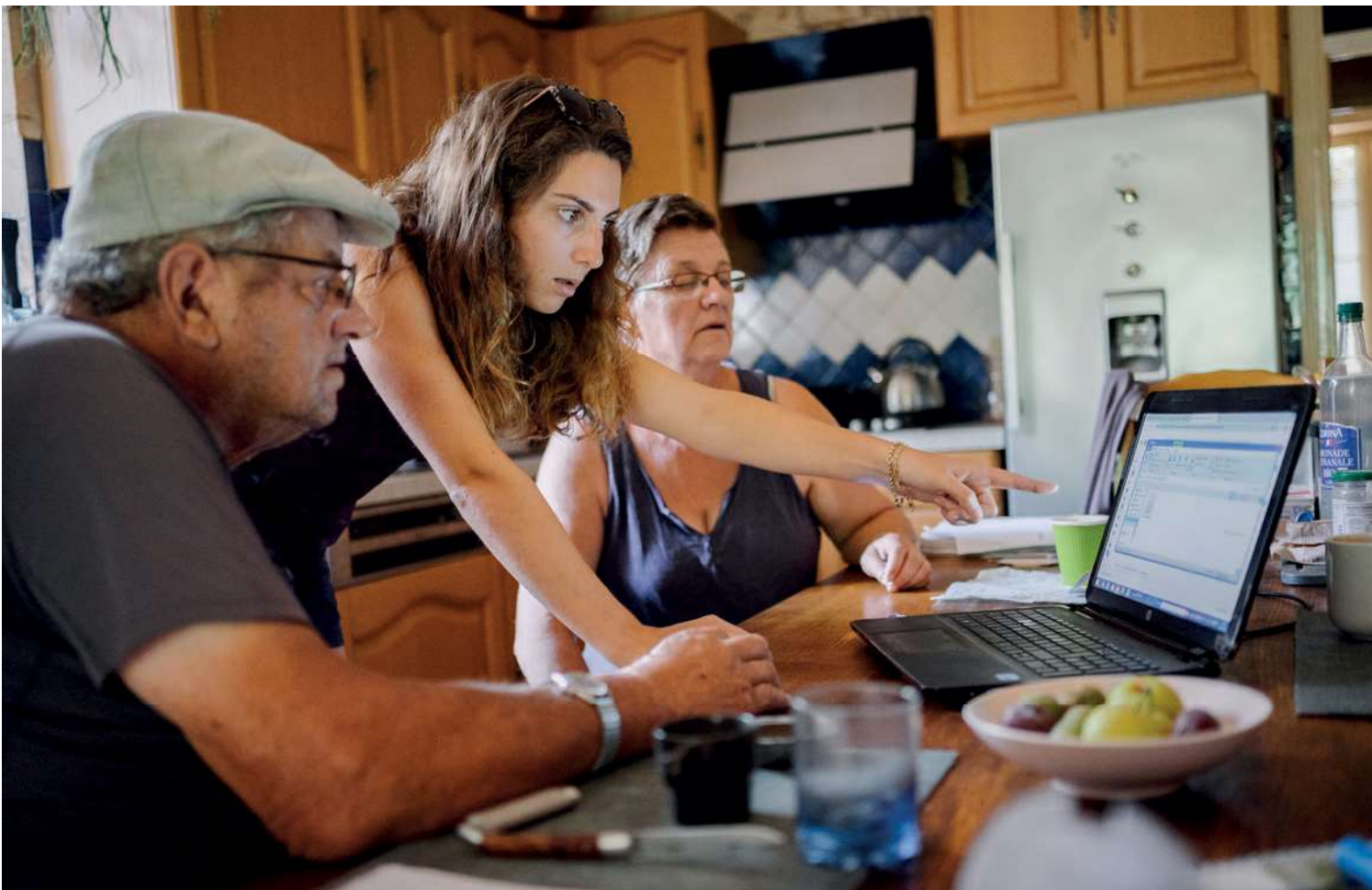

## Naïo's tools carrier



The Naïo tool-holder (*Reference: AM0013*) is the carrier which is designed to be compatible with the profen range of tools made by Naïo Technologies.

This carrier is composed of one parallelogram and allows you to set tools from the Naïo and Kult/HAK tools ranges. You can use three different toolbar holders (two inferiors and one superior).



**Naïo's tools carrier**  
*Reference: AM0013*



**Hoe blades (V shape) - 20cm**  
*Reference: AM0017*



**Coupling**  
*Reference: AM0016*



**Five-teeth harrow**  
*Reference: AM0020*

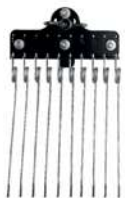

**Low spiked harrow (unit)**  
*Reference: AM0006*



**High spiked harrow (unit)**  
*Reference: AM0046*



**Right brush kit**  
*Reference: AM0004*



**Left brush kit**  
*Reference: AM0003*



**Side flange**  
For spiked harrows and brushes  
*Reference: AM0018*



**Short tool carrier extension (unit)**  
*Reference: AM0031*



**Torsion spring**  
To set on hoe blades, to work in-row (delivered without the blade)  
*Reference: AM0028*



## HAK's tools carrier



The Carrier bar for HAK parallelograms (*Reference: AH1330*) allows you to set up to three HAK parallelograms (*Reference: AH1287*).

Your Oz will have independent parallelograms, each one with its own yoke wheel. The perfect way to gain a fine and accurate weeding!

You can also use Naïo's and Kult's tools with HAK parallelograms.

Example of HAK set for side-weeding with Naïo's high spike warrow - *Reference: Oz-Kit-HAK-2*

Reference	Quantity	Description
AH1330	1	Toolbar
AH1287	3	HAK unit with one wheel
AH1326	1	Holder extension 3 pos
A0330	3	20 cm Hoeing blade – V knife (KULT)
AH1327	2	Tube holder 30x30 mm (HAK)
AH1396	2	Tube 300 mm x 30x30mm (KULT)
AM0046	2	Low spiked harrows
AM0018	2	Side flange (Naïo)

Example of Hak set for on-line weeding with three elements including one with double wheels -

*Reference: Oz-Kit-HAK-1*

Reference	Quantity	Description
AH1330	1	Toolbar
AH1489	1	HAK parallelogram with double 160x70 wheels
AH1423	1	HAK Cross bar
AH1506	2	HAK Grips 10x30 mm
AH1092	1	Lelievre Blade 12cm Right (KULT)
AH1086	1	Lelievre Blade 12cm Left (KULT)
AH1566	2	Cranked long rods 380 mm
AH1287	2	HAK unit with one wheel
AH1326	2	Holder extension 3 pos
A0330	2	20 cm Hoeing blade - V knife (KULT)







Carrier bar for HAK  
Reference: AH1330



HAK parallelogram with  
160x70 wheel  
Reference: AH1287



HAK parallelogram with  
double 160x70 wheel  
Reference: AH1489



3-position extension  
Reference: AH1326



HAK torsion weeder  
left side  
Reference: AH1288



HAK torsion weeder  
right side  
Reference: AH1289



HAK ridger 24 cm  
Reference: AH1290



HAK strop attachment  
For 10x30 mm on carrier bar  
50x50 mm  
Reference: AH1292



Tube holder 30x30cm  
Reference: AH1327



HAK ridging hoe  
left side  
Reference: AH1293



HAK ridging hoe  
right side  
Reference: AH1294



HAK convex discs  
(One pair with holders)  
Reference: AM0028



HAK Cross bar  
Reference: AH1423



HAK Grips 10x30 mm  
Reference: AH1506

## KULT's tools for Oz



16 cm Hoeing blade –  
V knife  
*Reference: A0329*



20 cm Hoeing blade –  
V knife  
*Reference: A0330*



KULT discs  
*Reference: AH1171*



KULT discs support  
*Reference: AH1172*



KULT T-fixation  
*Reference: AH1331*



Complete KULT discs kit  
*Reference: AH1166*



Lelievre Blade 18cm  
Right  
*Reference: AH1087*



Lelievre Blade 18cm Left  
*Reference: AH1147*



Lelievre Blade 12cm  
Right  
*Reference: AH1092*



Lelievre Blade 12cm  
Left  
*Reference: AH1086*



Long rod for L knives  
380 mm  
*Reference: AH1088*



Short tool holder for  
KULT 10x30 tools  
*Reference: A0503*



Long Tool holder 10x30  
*Reference: AH0676*



Tool holder extended  
50mm 10x30  
*Reference: AH1284*



Simple cross bar  
300x30x30 mm  
*Reference: AH1396*

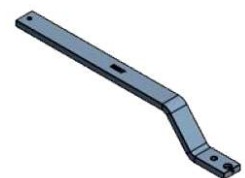

Cranked long rod  
380 mm  
*Reference: AH1566*



## Seeders

Ebra MS21 seed-drill



Reference	Description
AH1233	Ebra MS21 seeder unit
AH1234	Adaptation to couple seeder unit to the Oz

Reference	Seed for crops	Type
AH1235	Carrots, Turnips, Parsley	40 P1E
AH1236	Onion, Salad, Endive, Cabbage	40 P1
AH1237	Radish, Spinach, Lamb's lettuce	40 P4
AH1238	Parsnip	2 P6
AH1239	Beet	24 B6
AH1240	Peas	24 B10
AH1241	Green beans	10 M8



## Seeders

### Terradonis JPH seed-drill



Reference	Description
AH1303	Terradonis JPH seeder unit (1 row)
TLO01	Adaptation for Terradonis seeder unit

Reference	Seed for crops	Roll type
AH1444	Coco bean, Sweet corn, Barley, Rice, Rye	6-holes roll / A-6 / Terradonis
AH1445	Coco bean, Sweet corn, Rye	6-holes roll / AA-6 / Terradonis
AH1446	Fodder beet, sunflower	6-holes roll / C-6 / Terradonis



## Seeders

Terradonis JPH seed-drill

Reference	Seed for crops	Roll type
AHI447	Rapeseed, Spinach, Mustard, Lamb's lettuce, Watermelon, Radish	12-holes roll / FJ-12 / Terradonis
AHI448	Rapeseed, Spinach, Mustard, Lamb's lettuce, Radish	30-holes roll / FJ-24 / Terradonis
AHI449	Spinach, Mustard, Lamb's lettuce, Radish	36-holes roll / FJ-30 / Terradonis
AHI450	Spinach, Lamb's lettuce, Radish	6-holes roll / FJ-36 / Terradonis
AHI317	Lingot beans, Green beans, Melon	6-holes roll / JI-6 / Terradonis
AHI321	Lingot beans, Green beans	6-holes roll / J3-6 / Terradonis
AHI322	Lingot beans, Green beans	6-holes roll / J5-6 / Terradonis
AHI451	Lentil, Parsnip	12-holes roll / L-12 / Terradonis
AHI452	Lentil, Parsnip	24-holes roll / L-24 / Terradonis
AHI453	Chard, Okra	12-holes roll / LJ-12 / Terradonis
AHI454	Chilli, Pepper, Sorghum	2-holes roll / M-2 / Terradonis
AHI455	Beet, Coriander	12-holes roll / MJ-12 / Terradonis
AHI456	Lettuce (coated)	6-holes roll / MJ-6 / Terradonis
AHI457	Oats, Wheat, Barley, Peas, Snow pea, Soybean	6-holes roll / N-6 / Terradonis
AHI458	Watercress, Fennel, Millet, Onion (uncoated seed), rocket salad, Sage	12-holes roll / X-12 / Terradonis
AHI459	Millet, Sage, Tomato	2-holes roll / X-2 / Terradonis
AHI460	Watercress, Millet, Onion (Uncoated seed), Sage	24-holes roll / X-24 / Terradonis
AHI461	Onion (Uncoated seed)	30-holes roll / X-30 / Terradonis
AHI462	Onion (Uncoated seed)	36-holes roll / X-36 / Terradonis
AHI463	Chicory, Lettuce (uncoated seed)	12-holes roll / XY-12 / Terradonis

## Seeders

Terradonis JPH seed-drill

Reference	Seed for crops	Roll type
AHI318	Carrot	24-holes roll / XY-24 / Terradonis
AHI323	Carrot	30-holes roll / XY-30 / Terradonis
AHI464	Carrot	24-holes roll / XYY-24 / Terradonis
AHI465	Dill, Chicory, Lettuce (uncoated seed)	6-holes roll / XYY-6 / Terradonis
AHI466	chives, Flax, Leek	12-holes roll / Y-12 / Terradonis
AHI467	Eggplant	2-holes roll / Y-2 / Terradonis
AHI468	chives, Lin, Leek	24-holes roll / Y-24 / Terradonis
AHI469	Basilico, celery, lucerne, Turnip, Black Radis, Rosemary, Savory	12-holes roll / YX-12 / Terradonis
AHI470	Rosemary, Savory	2-holes roll / YX-2 / Terradonis
AHI471	Parsley	12-holes roll / YYJ-12 / Terradonis
AHI472	Parsley	24-holes roll / YYJ-24 / Terradonis
AHI473	Broccoli, Cabbage, Pak Choi, kale, Swede	6-holes roll / YYJ-6 / Terradonis
AHI474	Camomille, Lavander, Mint, Sorrel, Thyme	12-holes roll / YYX-12 / Terradonis
AHI475	Camomille, Lavander, Mint, Sorrel, Thyme	24-holes roll / YYX-24 / Terradonis
AHI476	All crops	virgin roll / Z / Terradonis
Other Terradonis accessories		
AHI235	Splitting hoe 60 mm / Terradonis	
AHI565	Disc soil opener	



## Robot accessories



In combination with the HAK tool holder and the parallelograms we recommend to keep the front weight on your Oz. This frontweight holder is base equipment of all Oz made in 2022.

To retrofit your Oz with a front weight kit we recommend to order the available retrofit bundle with the part number AMO241.



**Complete front weight kit**  
Reference: AMO241



**Front weight carrier**  
(25 kg) (part of AMO241)  
Reference: AMO263



**Additional front weight**  
1 kg - Max 8 units per robot  
(part of AMO241)  
Reference: FA1292



**Front board with extensions**  
(part of AMO241)  
Reference: AMO310



**Leaf bumper kit**  
For Oz without double wheels  
Reference: AM0027



**Double wheels kit - 4**  
Reference: AM0029



**Spring tooth harrow**  
(kit to build - 7 tooth)  
Reference: AM0311

## Coupling



**Coupling**  
Reference: AM0026



**Seat with drought beam**  
Reference: A0153



**Rear safety shunt kit**  
(delivered with all Oz above  
SN 150)  
Reference: AM0238



